



Pillai

Mahatma Education Society's

PILLAI HOC COLLEGE OF ARCHITECTURE

Pillai HOCL Educational Campus, HOC Colony, Rasayani, Via Panvel, Dist- Raigad, Pin: 410207

Tel: 02192- 252005 / 250066

Fax: 02192- 252062

Web: www.phcoa.ac.in

mail: phcarch@gmail.com

Approved by COA, Government of Maharashtra and Affiliated to University of Mumbai

Inst. Code- AR3427

STUDENT DEVELOPMENT PROGRAM
Learning | Growth | Projections

Vastu shastra.

For Registration: 

For further enquiry:
+91 8788268651
+91 8292858882

Faculty co ordinator
Prof. Sagarika M.
Prof. Rajnigandha C.

02 nd to 06 th May, 2023

10 am Onwards

Pillai HOC College of
Architecture

Pillai HOCL Educational
Campus, Rasayani

Eligibility for the course : Open to All participants
course fees : ₹ 200/- (For PHCOA) ₹ 1000/- (For Others)

  **PHCOA**
PILLAI HOC COLLEGE
OF ARCHITECTURE



Mahatma Education Society's

PILLAI HOC COLLEGE OF ARCHITECTURE

Pillai HOCL Educational Campus, HOC Colony, Rasayani, Via Panvel, Dist- Raigad, Pin: 410207

Tel: 02192- 252005 / 250066

Fax: 02192- 252062

Web: www.phcoa.ac.in

mail: phcarch@gmail.com

Approved by COA, Government of Maharashtra and Affiliated to University of Mumbai

Inst. Code- AR3427

VAASTU SHASTRA

Academic year: 2022-23

Organised by	Pillai HOC College of Architecture, Rasayani
Objectives	To understand the scientific approach towards Vaastu Shastra, its application in Architecture, and its relation with Numerology
Name of resource person(s)	Prof.Sagarika Mukherjee
Introduction about the resource person	Assistant professor at Pillai HOC College of Architecture, Rasayani, Vaastu consultant and freelancing architect
Date and time	2 ND May, 2023 – 6 th May, 2023
Venue	Pillai HOC College of Architecture, Rasayani
Faculty coordinator	Prof.Sagarika Mukherjee
Supporting staff	Prof.Rajnigandha Chowdhary
No. of students present	33
Program approved by	
Brief about the activity/event	India is one of the ancient civilizations of the world with its history going back as far as the Indus Valley civilization. House and family have always been an important part of Indian life, culture, and history. House has always been considered as a living being and has been designed as the adobe of Gods. Vaastu Shastra principles which have been developed over the ages were the guiding principles for the construction of houses, town planning, temple architecture, and sculpturing in India for centuries. Vaastu in the context of Vaastu Shastra means a place where immortals and mortals dwell. It, therefore, becomes imperative to understand and assimilate the Vaastu ideas into modern architecture. Vaastu Shastra depends on the movement of the Sun with respect to the structure and the 5 elements. Vaastu Shastra and modern planning share similar approaches and concepts in the organization and production of space, such as their emphasis on cardinal orientation, geomancy, topography, hydrology, etc. Both seek to achieve harmony between these spaces and the natural features and ecology within these spaces.



Mahatma Education Society's

PILLAI HOC COLLEGE OF ARCHITECTURE

Pillai HOCL Educational Campus, HOC Colony, Rasayani, Via Panvel, Dist- Raigad, Pin: 410207

Tel: 02192- 252005 / 250066

Fax: 02192- 252062

Web: www.phcoa.ac.in

mail: phcarch@gmail.com

Approved by COA, Government of Maharashtra and Affiliated to University of Mumbai

Inst. Code- AR3427

	<p>Assignments-</p> <ol style="list-style-type: none"> 1) Analysis of their own house plan as per Vaastu 360° 2) Analysis of few cities claimed to be planned as per Vaastu <ol style="list-style-type: none"> a) Harappan civilization b) Mohenjo-Daro c) Jaipur d) Temple architecture as per Vaastu 3) Analysis as per Numerology 																																																
<p>Outcomes</p>	<ol style="list-style-type: none"> 1) Understanding of Vaastu Shastra 2) Vaastu shastra and the science behind it 3) Vaastu shastra and numerology 4) Remedies 5) Practical analysis 																																																
<p>SDP Schedule</p>	<table border="1" style="width: 100%; border-collapse: collapse;"> <thead> <tr style="background-color: #92d050;"> <th colspan="3" style="text-align: center;">STUDENT DEVELOPMENT PROGRAM</th> </tr> <tr style="background-color: #e6f2ff;"> <th colspan="3" style="text-align: center;">VAASTU SHASTRA</th> </tr> <tr style="background-color: #fff2cc;"> <th style="width: 15%;">DAY</th> <th style="width: 15%;">TIME</th> <th style="width: 70%;">SCHEDULE</th> </tr> </thead> <tbody> <tr> <td>02-05-2023</td> <td>10AM - 1PM</td> <td>Brief introduction to the subject Introduction of the guest speaker Basic concept of Vaastu Vastupurush</td> </tr> <tr style="background-color: #fce4d6;"> <td colspan="3" style="text-align: center;">LUNCH BREAK</td> </tr> <tr> <td></td> <td>2PM - 4PM</td> <td>Importance of vaastu in day to-day life Importance of vaastu in architecture (land/house)</td> </tr> <tr> <td>03-05-2023</td> <td>10AM - 1PM</td> <td>Importance of all directions and its significance (negative and positives of each direction)</td> </tr> <tr style="background-color: #fce4d6;"> <td colspan="3" style="text-align: center;">LUNCH BREAK</td> </tr> <tr> <td></td> <td>2PM - 4PM</td> <td>Positioning of architectural elements as per Vaastu Positioning of Interior elements as per Vaastu</td> </tr> <tr> <td>04-05-2023</td> <td>10AM - 1PM</td> <td>Introduction to numerology Loshu grid (DOB)</td> </tr> <tr style="background-color: #fce4d6;"> <td colspan="3" style="text-align: center;">LUNCH BREAK</td> </tr> <tr> <td></td> <td>2PM - 4PM</td> <td>How to analyze vaastu using numerology Assignment</td> </tr> <tr> <td>05-05-2023</td> <td>10AM - 1PM</td> <td>Assignment Question answer session</td> </tr> <tr style="background-color: #fce4d6;"> <td colspan="3" style="text-align: center;">LUNCH BREAK</td> </tr> <tr> <td></td> <td>2PM - 4PM</td> <td>Assignment</td> </tr> <tr> <td>06-05-2023</td> <td>10AM - 1PM</td> <td>Assignment discussion and submission</td> </tr> </tbody> </table>	STUDENT DEVELOPMENT PROGRAM			VAASTU SHASTRA			DAY	TIME	SCHEDULE	02-05-2023	10AM - 1PM	Brief introduction to the subject Introduction of the guest speaker Basic concept of Vaastu Vastupurush	LUNCH BREAK				2PM - 4PM	Importance of vaastu in day to-day life Importance of vaastu in architecture (land/house)	03-05-2023	10AM - 1PM	Importance of all directions and its significance (negative and positives of each direction)	LUNCH BREAK				2PM - 4PM	Positioning of architectural elements as per Vaastu Positioning of Interior elements as per Vaastu	04-05-2023	10AM - 1PM	Introduction to numerology Loshu grid (DOB)	LUNCH BREAK				2PM - 4PM	How to analyze vaastu using numerology Assignment	05-05-2023	10AM - 1PM	Assignment Question answer session	LUNCH BREAK				2PM - 4PM	Assignment	06-05-2023	10AM - 1PM	Assignment discussion and submission
STUDENT DEVELOPMENT PROGRAM																																																	
VAASTU SHASTRA																																																	
DAY	TIME	SCHEDULE																																															
02-05-2023	10AM - 1PM	Brief introduction to the subject Introduction of the guest speaker Basic concept of Vaastu Vastupurush																																															
LUNCH BREAK																																																	
	2PM - 4PM	Importance of vaastu in day to-day life Importance of vaastu in architecture (land/house)																																															
03-05-2023	10AM - 1PM	Importance of all directions and its significance (negative and positives of each direction)																																															
LUNCH BREAK																																																	
	2PM - 4PM	Positioning of architectural elements as per Vaastu Positioning of Interior elements as per Vaastu																																															
04-05-2023	10AM - 1PM	Introduction to numerology Loshu grid (DOB)																																															
LUNCH BREAK																																																	
	2PM - 4PM	How to analyze vaastu using numerology Assignment																																															
05-05-2023	10AM - 1PM	Assignment Question answer session																																															
LUNCH BREAK																																																	
	2PM - 4PM	Assignment																																															
06-05-2023	10AM - 1PM	Assignment discussion and submission																																															

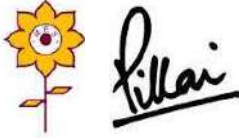

Mahatma Education Society's

PILLAI HOC COLLEGE OF ARCHITECTURE

Pillai HOCL Educational Campus, HOC Colony, Rasayani, Via Panvel, Dist- Raigad, Pin: 410207

Tel: 02192- 252005 / 250066

Fax: 02192- 252062

Web: www.phcoa.ac.in

mail: phcarch@gmail.com

Approved by COA, Government of Maharashtra and Affiliated to University of Mumbai

Inst. Code- AR3427

Photographs

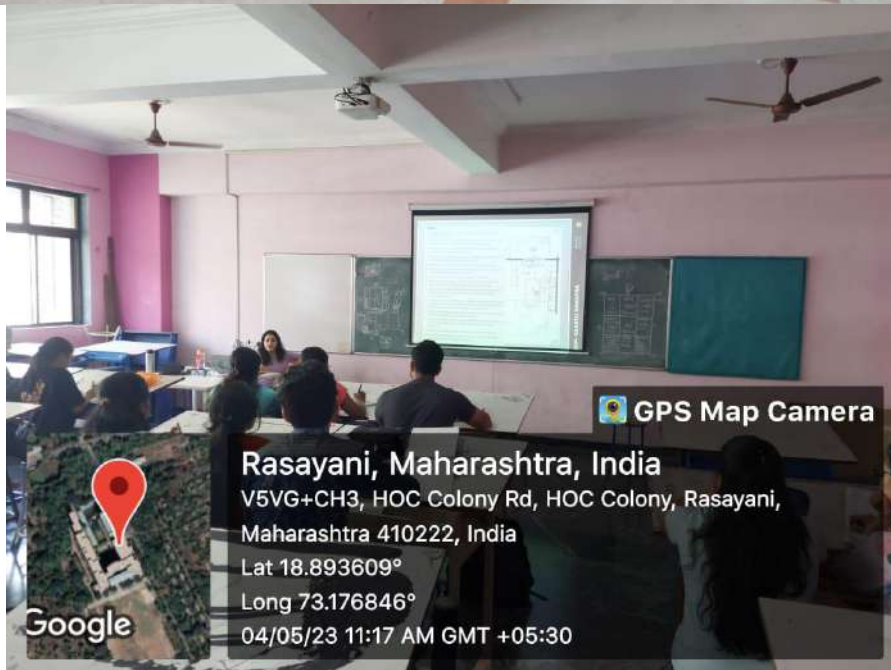



Pillai

Mahatma Education Society's

PILLAI HOC COLLEGE OF ARCHITECTURE

Pillai HOCL Educational Campus, HOC Colony, Rasayani, Via Panvel, Dist- Raigad, Pin: 410207

Tel: 02192- 252005 / 250066

Fax: 02192- 252062

Web: www.phcoa.ac.in

mail: phcarch@gmail.com

Approved by COA, Government of Maharashtra and Affiliated to University of Mumbai

Inst. Code- AR3427

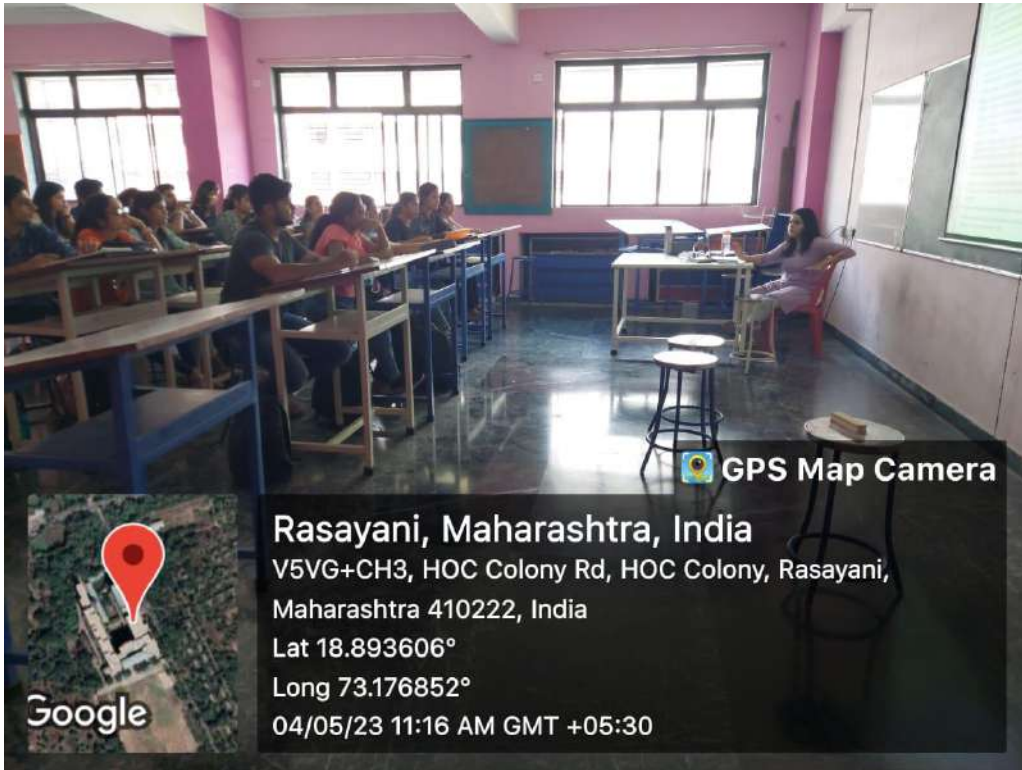



Pillai

Mahatma Education Society's

PILLAI HOC COLLEGE OF ARCHITECTURE

Pillai HOCL Educational Campus, HOC Colony, Rasayani, Via Panvel, Dist- Raigad, Pin: 410207

Tel: 02192- 252005 / 250066

Fax: 02192- 252062

Web: www.phcoa.ac.in

mail: phcarch@gmail.com

Approved by COA, Government of Maharashtra and Affiliated to University of Mumbai

Inst. Code- AR3427



Attendance –



Pillai

Mahatma Education Society's

PILLAI HOC COLLEGE OF ARCHITECTURE

Pillai HOCL Educational Campus, HOC Colony, Rasayani, Via Panvel, Dist- Raigad, Pin: 410207

Tel: 02192- 252005 / 250066

Fax: 02192- 252062

Web: www.phcoa.ac.in

mail: phcarch@gmail.com

Approved by COA, Government of Maharashtra and Affiliated to University of Mumbai

Inst. Code- AR3427

UNIVERSITY OF MUMBAI MAHATMA EDUCATION SOCIETY'S PILLAI HOC COLLEGE OF ARCHITECTURE, RASAYANI Pillai HOCL Educational Campus via Panvel, Dist. Raigad - 410207 ACADEMIC YEAR (2022-23)												
STUDENT DEVELOPMENT PROGRAM												
Course Name		Vaastu Shastra										
Course Co-ordinator		Prof. Sagarika Mukherjee, Prof. Rajnigandha Chowdhary										
Classroom		Studies - 407-409										
Name of the student	Semester	Division	02/05/2023	Sign	03/05/2023	Sign	04/05/2023	Sign	05/05/2023	Sign	06/05/2023	Sign
Pallavi Pradeep Gaiwad	Semester 6	B	P	<i>[Signature]</i>	P	<i>[Signature]</i>	P	<i>[Signature]</i>	P	<i>[Signature]</i>	P	<i>[Signature]</i>
Mansi Sadashiv Sase	Semester 6	A	P	<i>[Signature]</i>	P	<i>[Signature]</i>	P	<i>[Signature]</i>	P	<i>[Signature]</i>	P	<i>[Signature]</i>
Piyusha Mhatre	Semester 6	B	P	<i>[Signature]</i>	P	<i>[Signature]</i>	P	<i>[Signature]</i>	P	<i>[Signature]</i>	P	<i>[Signature]</i>
Pooja Laxman Dhuri	Semester 6	B	P	<i>[Signature]</i>	P	<i>[Signature]</i>	P	<i>[Signature]</i>	P	<i>[Signature]</i>	P	<i>[Signature]</i>
sakshi nishant sakhar	Semester 6	A	P	<i>[Signature]</i>	P	<i>[Signature]</i>	P	<i>[Signature]</i>	P	<i>[Signature]</i>	P	<i>[Signature]</i>
Shreyash Dattatray Shinde	Semester 6	A	P	<i>[Signature]</i>	P	<i>[Signature]</i>	P	<i>[Signature]</i>	P	<i>[Signature]</i>	P	<i>[Signature]</i>
UTKARSHA PURUSHOTTAM RANBHO	Semester 6	A	P	<i>[Signature]</i>	P	<i>[Signature]</i>	P	<i>[Signature]</i>	P	<i>[Signature]</i>	P	<i>[Signature]</i>
Bhairavi Patil	Semester 6	B	P	<i>[Signature]</i>	P	<i>[Signature]</i>	P	<i>[Signature]</i>	P	<i>[Signature]</i>	P	<i>[Signature]</i>
Pragati Dattatray Sannake	Semester 9	B	P	<i>[Signature]</i>	P	<i>[Signature]</i>	P	<i>[Signature]</i>	P	<i>[Signature]</i>	P	<i>[Signature]</i>
Priyal dinesh polphode	Semester 9	A	P	<i>[Signature]</i>	P	<i>[Signature]</i>	P	<i>[Signature]</i>	P	<i>[Signature]</i>	P	<i>[Signature]</i>

Total no. of participants:

Signature of Faculty Incharge

[Signature]

UNIVERSITY OF MUMBAI MAHATMA EDUCATION SOCIETY'S PILLAI HOC COLLEGE OF ARCHITECTURE, RASAYANI Pillai HOCL Educational Campus via Panvel, Dist. Raigad - 410207 ACADEMIC YEAR (2022-23)												
STUDENT DEVELOPMENT PROGRAM												
Course Name		Vaastu Shastra										
Course Co-ordinator		Prof. Sagarika Mukherjee, Prof. Rajnigandha Chowdhary										
Classroom		Studies - 407-409										
Name of the student	Semester	Division	02/05/2023	Sign	03/05/2023	Sign	04/05/2023	Sign	05/05/2023	Sign	06/05/2023	Sign
Aishwarya Shrivastava	Semester 2		P	<i>[Signature]</i>	P	<i>[Signature]</i>	P	<i>[Signature]</i>				
Aman Govinda Arebail	Semester 2		P	<i>[Signature]</i>	P	<i>[Signature]</i>	P	<i>[Signature]</i>				
Harshi Gupta	Semester 2		P	<i>[Signature]</i>	P	<i>[Signature]</i>	P	<i>[Signature]</i>				
Prachi Jivan Naik	Semester 2		P	<i>[Signature]</i>	P	<i>[Signature]</i>	P	<i>[Signature]</i>				
Shravani Prakash chavan	Semester 2		P	<i>[Signature]</i>	P	<i>[Signature]</i>	P	<i>[Signature]</i>				
Avanika Milind Wanj	Semester 6	B	P	<i>[Signature]</i>	P	<i>[Signature]</i>	P	<i>[Signature]</i>	<i>[Signature]</i>		<i>[Signature]</i>	
Gatbrooh M. Ghangurde	Semester 6	A	P	<i>[Signature]</i>	P	<i>[Signature]</i>	P	<i>[Signature]</i>	<i>[Signature]</i>		<i>[Signature]</i>	
Kashmira Paranjape	Semester 6	B	P	<i>[Signature]</i>	P	<i>[Signature]</i>	P	<i>[Signature]</i>	<i>[Signature]</i>		<i>[Signature]</i>	
PRACHI R. PALKAR	Semester 6	A	P	<i>[Signature]</i>	P	<i>[Signature]</i>	P	<i>[Signature]</i>	P	<i>[Signature]</i>	<i>[Signature]</i>	<i>[Signature]</i>
Pranisha mhatre	Semester 6	B	P	<i>[Signature]</i>	P	<i>[Signature]</i>	P	<i>[Signature]</i>	<i>[Signature]</i>		<i>[Signature]</i>	<i>[Signature]</i>

Total no. of participants:

Signature of Faculty Incharge

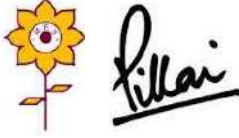

Mahatma Education Society's

PILLAI HOC COLLEGE OF ARCHITECTURE

Pillai HOCL Educational Campus, HOC Colony, Rasayani, Via Panvel, Dist- Raigad, Pin: 410207

Tel: 02192- 252005 / 250066

Fax: 02192- 252062

Web: www.phcoa.ac.in

mail: phcarch@gmail.com

Approved by COA, Government of Maharashtra and Affiliated to University of Mumbai

Inst. Code- AR3427

UNIVERSITY OF MUMBAI MAHATMA EDUCATION SOCIETY'S PILLAI HOC COLLEGE OF ARCHITECTURE, RASAYANI Pillai HOCL Educational Campus via Panvel, Dist. Raigad - 410207												
ACADEMIC YEAR (2022-23)												
STUDENT DEVELOPMENT PROGRAM												
Course Name	Vaastu Shastra											
Course Co-ordinator	Prof. Sagarika Mukherjee, Prof. Rajnigandha Chowdhary											
Classroom	Studios - 407-409											
ATTENDANCE												
Name of the student	Semester	Division	02/05/2023	Sign	03/05/2023	Sign	04/05/2023	Sign	05/05/2023	Sign	06/05/2023	Sign
Rashmi mahato	Semester 6	B			P	<i>Rashmi</i>	P	<i>Rashmi</i>		<i>Rashmi</i>		<i>Rashmi</i>
Sakshi santosh nalawade	Semester 6	A										
Shardul Lalit Mahajan	Semester 6	B	P	<i>Shardul</i>	P	<i>Shardul</i>	P	<i>Shardul</i>		<i>Shardul</i>		<i>Shardul</i>
Shravan Mane	Semester 6	A	P	<i>Shravan</i>	P	<i>Shravan</i>	P	<i>Shravan</i>		<i>Shravan</i>		<i>Shravan</i>
SHRUTI SONAR	Semester 6	A	P	<i>Shruti</i>	P	<i>Shruti</i>	P	<i>Shruti</i>		<i>Shruti</i>		<i>Shruti</i>
Soham vinayak jadhav	Semester 6	B	P	<i>Soham</i>	P	<i>Soham</i>	P	<i>Soham</i>		<i>Soham</i>		<i>Soham</i>
Vedika Dhananjay Kadam	Semester 6	B										
Anish Thakur	Semester 4											

Total no. of participants:

Signature of Faculty Incharge



Pillai

Mahatma Education Society's

PILLAI HOC COLLEGE OF ARCHITECTURE

Pillai HOC Educational Campus, HOC Colony, Rasayani, Via Panvel, Dist- Raigad, Pin: 410207

Tel: 02192- 252005 / 250066

Fax: 02192- 252062

Web: www.phcoa.ac.in

mail: phcarch@gmail.com

Approved by COA, Government of Maharashtra and Affiliated to University of Mumbai

Inst. Code- AR3427

UNIVERSITY OF MUMBAI
PILLAI HOC COLLEGE OF ARCHITECTURE, RASAYANI
Pillai HOC Educational Campus via Panvel, Dist. Raigad - 410207

ACADEMIC YEAR (2022-23)
STUDENT DEVELOPMENT PROGRAM

Course Name	Vaastu Shastra		
Course Co-ordinator	Prof.Sagarika Mukherjee, Prof. Rajnigandha Chowdhary		
Classroom	Studios - 407-409		

Name of the student	Semester	Division	ATTENDANCE											
			02/05/2023	Sign	03/05/2023	Sign	04/05/2023	Sign	05/05/2023	Sign	06/05/2023	Sign		
Pranay Thakur	Semester 9	A	P	[Signature]	P	[Signature]	P	[Signature]	P	[Signature]	P	[Signature]	P	[Signature]
✓ Darshana Pandare	Semester 9	B	P	[Signature]	P	[Signature]	P	[Signature]	P	[Signature]	P	[Signature]	P	[Signature]
Anish Thakur	Semester 4													
Raj Mahtre	Semester 9		P	[Signature]	P	[Signature]	P	[Signature]					P	[Signature]

Total no. of participants:

Signature of Faculty Incharge
PIYANSH SAGALGILE SEM 6 B P [Signature] P [Signature] P [Signature] [Signature] [Signature]

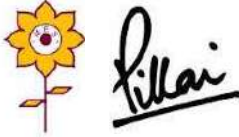

Mahatma Education Society's

PILLAI HOC COLLEGE OF ARCHITECTURE

Pillai HOCL Educational Campus, HOC Colony, Rasayani, Via Panvel, Dist- Raigad, Pin: 410207

Tel: 02192- 252005 / 250066

Fax: 02192- 252062

Web: www.phcoa.ac.in

mail: phcarch@gmail.com

Approved by COA, Government of Maharashtra and Affiliated to University of Mumbai

Inst. Code- AR3427

Assignments –

DATE OF BIRTH - 27/06/2001

$$9 + 6 + 3$$

$$1 + 8 = 9$$

9 = BIRTH NUMBER 9 = PATH NUMBER

4	9	2
3	5	7
8	1	6

4	9	2
3	5	7
8	1	6

RAHU	MARS	MOON
JUPITER	MERCURY	KETU
SATURN	SUN	VENUS

- (1) CARRER & SUCESS (2) MARRIAGE & RELATIONSHIP (3) HEALTH & FAMILY (4) MONEY & PROSPERITY (5) ENERGY & STABILITY (6) FREINDS & BEGNINGS (7) CHILDREN & CREATIVITY (8) KNOWLEDGE & INTITION (9) FAME & PROSPERITY



Pillai

Mahatma Education Society's

PILLAI HOC COLLEGE OF ARCHITECTURE

Pillai HOCL Educational Campus, HOC Colony, Rasayani, Via Panvel, Dist- Raigad, Pin: 410207

Tel: 02192- 252005 / 250066

Fax: 02192- 252062

Web: www.phcoa.ac.in

mail: phcarch@gmail.com

Approved by COA, Government of Maharashtra and Affiliated to University of Mumbai

Inst. Code- AR3427



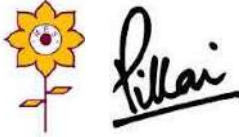

Mahatma Education Society's
PILLAI HOC COLLEGE OF ARCHITECTURE

Pillai HOCL Educational Campus, HOC Colony, Rasayani, Via Panvel, Dist- Raigad, Pin: 410207

Tel: 02192- 252005 / 250066

Fax: 02192- 252062

Web: www.phcoa.ac.in

mail: phcarch@gmail.com

Approved by COA, Government of Maharashtra and Affiliated to University of Mumbai

Inst. Code- AR3427

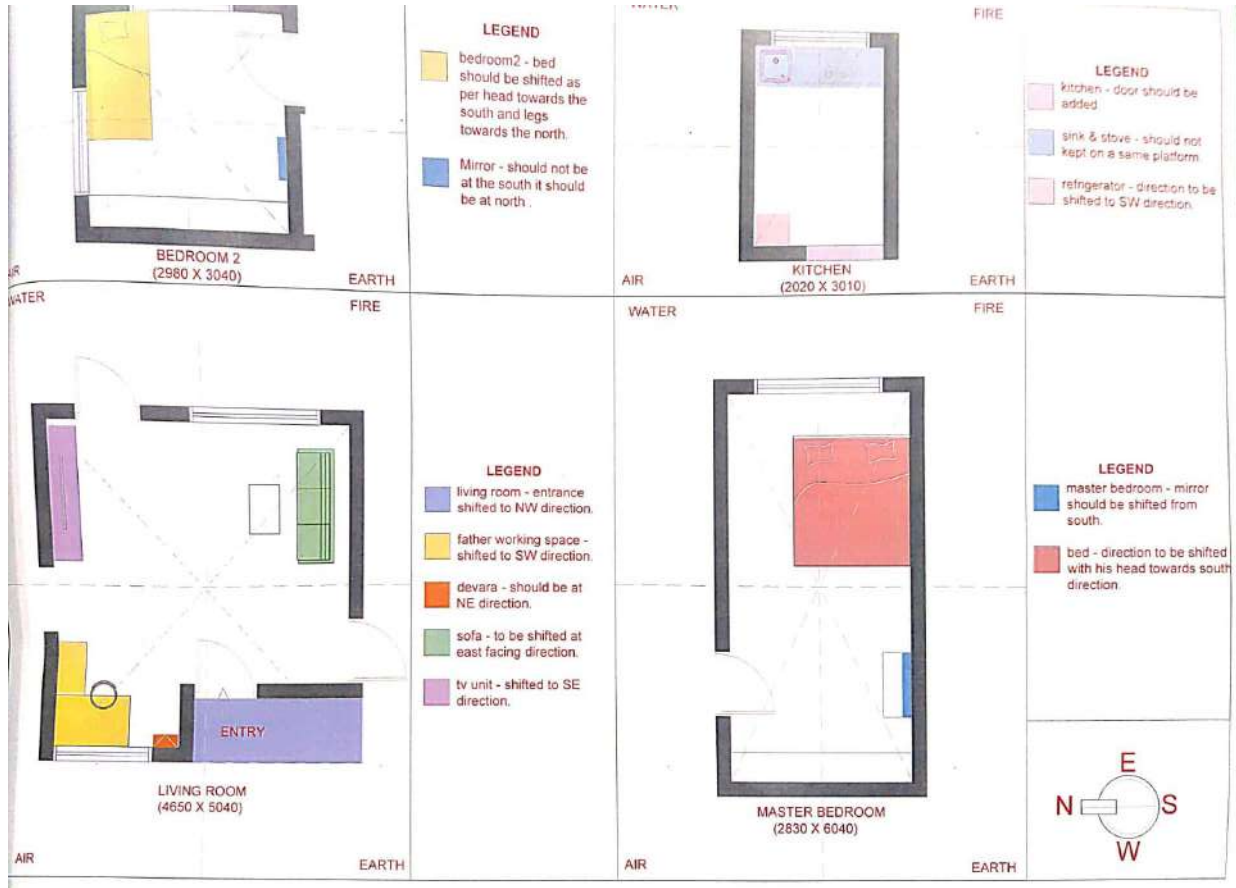

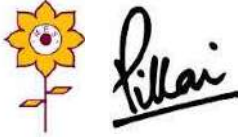

Mahatma Education Society's
PILLAI HOC COLLEGE OF ARCHITECTURE

Pillai HOCL Educational Campus, HOC Colony, Rasayani, Via Panvel, Dist- Raigad, Pin: 410207

Tel: 02192- 252005 / 250066

Fax: 02192- 252062

Web: www.phcoa.ac.in

mail: phcarch@gmail.com

Approved by COA, Government of Maharashtra and Affiliated to University of Mumbai

Inst. Code- AR3427

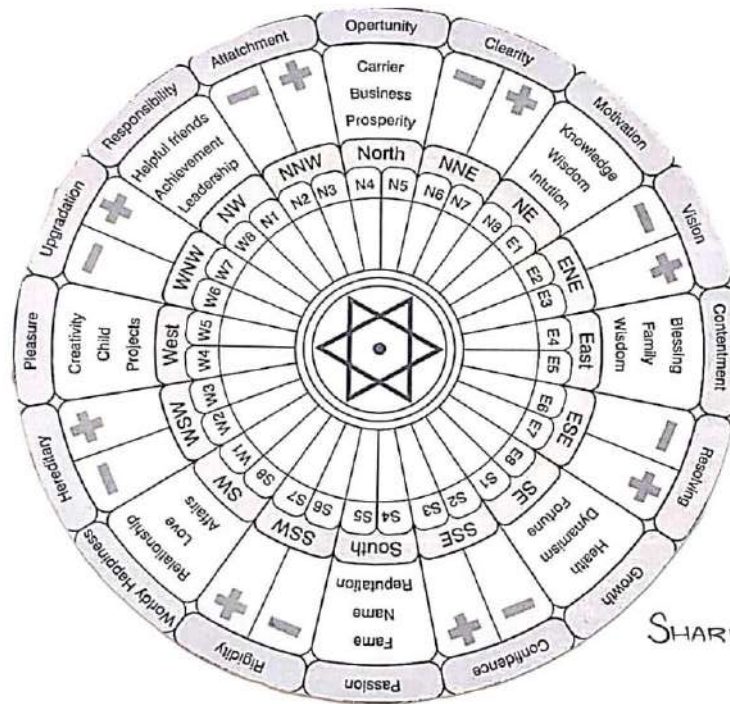

SHARDUL

VAASTU SHASTRA - HOUSE PLAN:

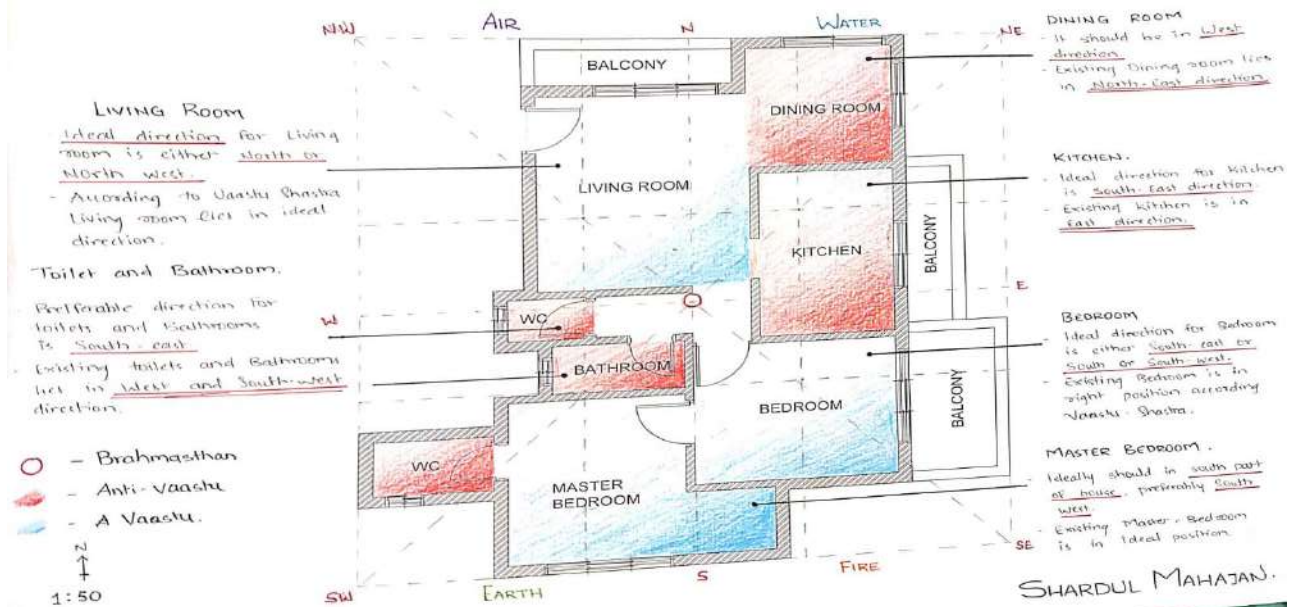



Pillai

Mahatma Education Society's

PILLAI HOC COLLEGE OF ARCHITECTURE

Pillai HOCL Educational Campus, HOC Colony, Rasayani, Via Panvel, Dist- Raigad, Pin: 410207

Tel: 02192- 252005 / 250066

Fax: 02192- 252062

Web: www.phcoa.ac.in

mail: phcarch@gmail.com

Approved by COA, Government of Maharashtra and Affiliated to University of Mumbai

Inst. Code- AR3427

VAASTU SHASTRA - INDIVIDUAL SPACES.

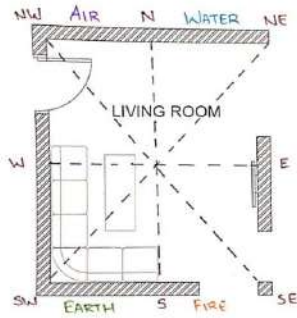

SPACES	FAULTS	SOLUTION / REMEDIES
LIVING ROOM	Seating /Sofa is in Earth element.	Shifting the sofa in other direction. Wind-chime in AIR element.
DINING ROOM	Dining table slightly curve on corners.	Changing the glass of the table. Head of the family, or his wife, his eldest son should sit on the South, south-west, West side of the room.

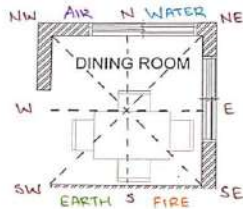

SHARDUL MAHAJAN.

VAASTU SHASTRA - INDIVIDUAL SPACES

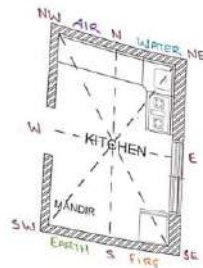

SPACES	FAULTS	Solution / Remedies.
KITCHEN	Gas stove is in water element	shifting the Gas stove in fire element.
MASTER BEDROOM	While sleeping, head is pointing towards West.	Rotating bed 90° in Anti-clockwise direction.



SHARDUL MAHAJAN.



Pillai

Mahatma Education Society's

PILLAI HOC COLLEGE OF ARCHITECTURE

Pillai HOCL Educational Campus, HOC Colony, Rasayani, Via Panvel, Dist- Raigad, Pin: 410207

Tel: 02192- 252005 / 250066

Fax: 02192- 252062

Web: www.phcoa.ac.in

mail: phcarch@gmail.com

Approved by COA, Government of Maharashtra and Affiliated to University of Mumbai

Inst. Code- AR3427

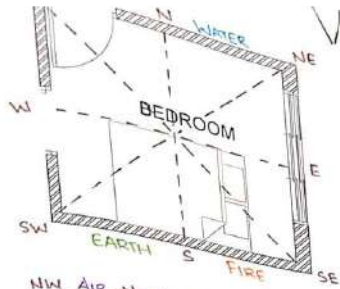

VAASTU SHASTRA - INDIVIDUAL SPACES

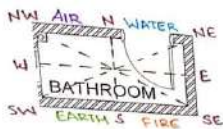
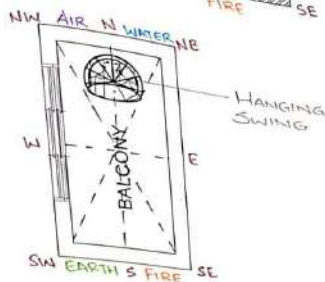

SPACES	FAULTS	SOLUTION / REMEDIES
BEDROOM	Bed is in mostly South and South-east direction.	Couple who have established their family should have their Bed in South-west direction. Shifting the bed towards south-west.
BALCO BALCONY.	Swing is facing South.	Rotating 90° Anti-clockwise direction (towards east).
Bathroom	Geyser is in North-west direction.	Shifting the geyser towards South-east.
TOILET	For Toilet should have cross ventilation. existing toilet do not have cross ventilation.	Placing a exhaust Fan.

SHARDUL MAHAJ